

Eclipse® Boot

Super absorbent leg wrap dressing

Fact sheet

Product description

Eclipse® Boot is a super absorbent dressing, anatomically designed to be applied securely to the lower limb area to manage wound exudate.

Use

Open out the dressing fully, white side up placing the heel onto the small triangle, the top of the triangle pointing towards the patient. Fold over the foot one at a time the smaller sections to the left and right and secure with tape. Fold both the larger sections one at a time around the leg also securing with tape. Eclipse® Boot can be used under compression bandaging.

Wear time will depend on the level of exudate, daily changes may be required, but Eclipse® Boot can be left in place for up to seven days.

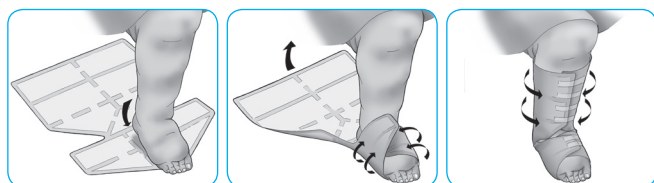

Contra-indications

Arterial bleeds and heavily bleeding wounds.
Do not cut Eclipse® Boot across the absorbent pockets.

Storage

Store at room temperature, out of direct sunlight and keep dry.

Ordering information for Eclipse® Boot

Size	Stock code	Pack size	NHS code	PIP code
55cm x 47cm	CR4237	5	EJE085	380-4630
60cm x 70cm	CR4014	5	EME042	347-6207



Features









- ✓ Rapid absorption
- ✓ High capacity
- ✓ Fluid repellent backing
- ✓ Strength and durability
- ✓ Stay dry technology
- ✓ Thin and conforming
- ✓ Single dressing - no patchwork dressings

Indications

Moderate to heavily exuding wounds:

- ✓ Leg ulcers
- ✓ Superficial wounds
- ✓ Pressure ulcers
- ✓ Arterial ulcers
- ✓ Leaky legs
- ✓ Diabetic ulcers
- ✓ Lymphoedema

Care and use symbols

-  Read instructions for use
-  Single use only
-  Do not use if packaging is broken or damaged
-  STERILE EO Sterilised using ethylene oxide
-  CE 0120 CE marked medical device
-  Keep dry
-  Store out of direct sunlight
-  Do not re-sterilize

TOP TIP

Eclipse® dressings should not be cut across the absorbent pockets, however Eclipse® Boot can be cut along the welded seam to fit a shorter leg/area.

Advancis
Medical
www.advancis.co.uk